

# HANGING RECOMMENDATIONS

## DRY ERASE SURFACES : TRIM and TRAY installation

---

### J trim installation

#### Materials needed:

- Level
- Chalk Line
- 12mm double sided tape
- Jointing compound
- Mitre saw

1. Examine trim to assure quantity and quality is as ordered. The installer must supply the double sided high contact self adhesive tape to adhere the trim.
2. With a pencil, lightly mark the perimeter of the area to receive the trim and Tekwrite wallcovering on the wall.
3. Measure and cut trim to size using a mitre saw or aluminium chop saw . For picture framing cut the ends of each piece to a 45 degree angle.
4. Apply double faced tape to the backside of the trim and adhere to the wall.
5. With a broad knife, feather the drywall compound to the highest point on the long leg of the trim. *see diagram*
6. Measure material to fit into affixed J-trim recess, allow approx 4mm.

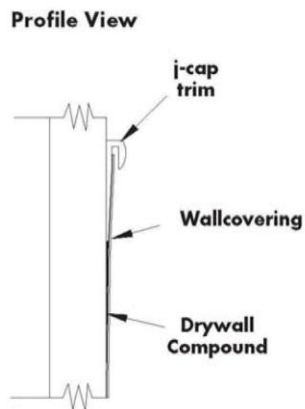

**BE CAREFUL NOT TO DAMAGE OR DENT TRIM**

# Pen tray installation

## Materials needed:

- Level
- Chalk Line
- Screws and anchors
- Rubber mallet
- Screwdriver
- Wood block
- Hammer
- Mitre saw

1. Once Tekwrite / Clear Erase is installed determine the height at which to position the pen tray.
2. The tray should be fastened so that the top edge overlaps the bottom of the dry erase surface.
3. Place two marks on opposite ends 3cms above the point where the top of the tray will be fastened. If using tray end caps, allow 3cms on each end for the width of the end cap. Trays butting to a wall do not require end caps.
4. Snap chalk line on these marks.
5. Fasten large clips into wall studs (no further than 5cms on centre) with screws. If unable to fit wall studs use the appropriate anchors to fasten the clip to the wall. Clips should be fastened curved side down. If using end caps position clip at least 5 cms from the end of the tray so that the end cap may slide into place. If using 2 adjoining tray pieces, centre a clip at the butt joint.
6. Rest top of tray against the wall on the back of the blade part of clip. Centre tray and gently snap into place. Use rubber mallet if necessary. If using end caps slide on to each end of tray at this time. If necessary screw or rivet end cap to the tray. End cap fasteners can be screwed into the top back ridge of the tray and/or under bottom of the tray.
7. From the edge of the tray (including end cap) measure desired height of trim for each side. Top trim piece is equal to the length of the tray. Trim may be butted to top of the tray; upper corners need to be mitred for 90° angles
8. Place a mark 3cms in from the end of the tray and 10cms in from the top trim. Place marks 3cms from top of trim on each end. Snap chalk line for top and side pieces. Place small clips with curved side towards middle of the board and fasten clips until screws are snug. Clips should be approximately 60cms apart. If using two adjoining pieces of trim, centre a clip at the butt joint.
9. Place trim against the wall over the blade part of clip. Gently snap into place. Use rubber mallet if necessary. Gently tap trim with wood block and hammer until all corners are neatly joined. All material claims must be made within 3 days.

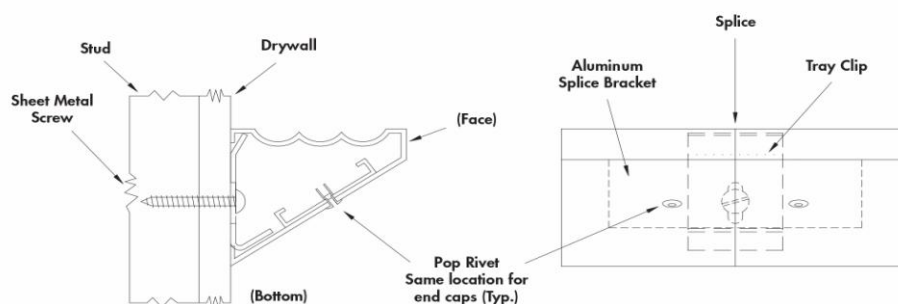

TEKTURA  
WALLCOVERINGS

TEKTURA PLC, 34 Harbour Exchange Square, London E14 9GE  
Tel London 020 7536 3300 / Glasgow 0141 248 9888 / Manchester 0161 876 5300 / Dublin 01 284 1788